



Downloading and Installing Updates Automatically

Note: You must be connected to WiFi to download updates automatically!!

The “Allow WiFi Download” and “Auto Install” options are selected by default on your device. Leave both options selected. To verify that the options are selected are selected:

1. Choose **Menu**  > **Help** > **Check for Updates** > **Menu** .



2. If either option is not selected, select the box to insert a green checkmark.

To check for, download, and install updates:

1. Choose **Menu**  > **Help**. The Help screen will be displayed.

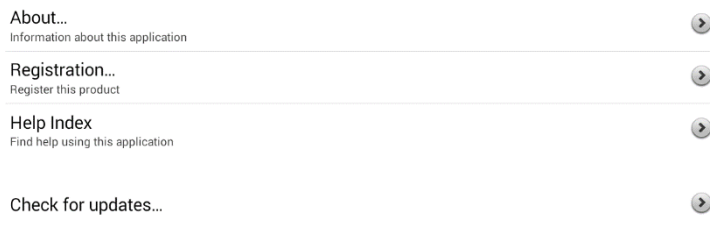

2. Choose **Check for Updates**. A screen will show “Check Now” along with the current software version, when you last checked for updates, and the date and time of the last update.

1.12.0-62-gb3dd24c

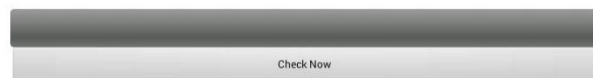

Last Check: Jan 23, 2000 5:23 PM
Last Update: Jan 23, 2000 5:28 PM

3. To check for available updates, choose **Check Now**. When the system finds one or more updates to install, a window will give you the option to install the update software or cancel.

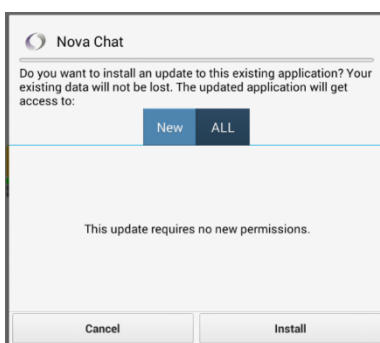

4. Choose **Install**. “Installing” will be displayed below a progress bar while the installation is in progress.



Last Check: Jan 23, 2000 5:23 PM
Last Update: Never

Note: The number of updates to install can vary. When prompted, follow the on-screen instructions.

5. When the installation is complete, the screen will show “The Update Completed Successfully”.